



**ISB**  
INTERNATIONAL  
SOCIETY OF  
BIOMETEOROLOGY

# 24<sup>th</sup> International Congress of Biometeorology

*„Biometeorology:  
Addressing 21<sup>st</sup> century global climate issues  
and perspectives of living beings and places“*

## ICB2026

– First Call –

*(information about Congress venue, travel and ICB organization)*

**July 13-16, 2026**

Novi Sad, SERBIA

[Congress info link](#)



# WELCOME TO REPUBLIC OF SERBIA

## WELCOME TO NOVI SAD

*The second largest city in Serbia and capital of the Autonomous Province of Vojvodina*





## CONGRESS VENUE

University of Novi Sad, Faculty of Sciences (Novi Sad, SERBIA)

Address: Trg Dositeja Obradovica 2-4, 21000 Novi Sad, SERBIA (EUROPE)

[Location on the GoogleMap](#)

[Street view](#)

The Faculty of Sciences employs 615 staff and educates around 6000 students. The Faculty's mission is to create the state-of-the-art knowledge through education and research, to safeguard research integrity, to facilitate career development of its staff, and to attract external funding to achieve full integration into the European Research and Higher Education Area. The Faculty of Sciences developed the internal strategy on enhancing the educational and research processes, quality assurance mechanisms, internationalization, which heavily rely on capacity building, interactive networking, international scientific projects, academic mobility at all levels, and visibility on a global scale.

The Faculty is strategically oriented to the EU and other available external funding which serve to unlock its potential and fully employ its excellence (Horizon Europe; IPA Interreg Cross-border and Transnational Cooperation Programs; Erasmus Plus). The goal is to internationalize education and research, boost human resources and capacity building, and increase the overall institutional excellence. Faculty of Sciences has been acknowledged and recognized by the *European Commission's Innovation Radar* as an innovator in the category of *ADMM Machine Learning Algorithms*, which is market ready, and is the result of the Horizon 2020 project

called I-BiDaaS. Research teams are focused on various aspects of environmental issues, and up to now a few international projects are realized (URBAN-PATH, URBAN-PREX, GReENERGY, GReENERGY2.0, CREATE-GREEN, INTERCLIM) with a special focus on urban environment. Overview of international collaboration projects is available at <https://www.pmf.uns.ac.rs/en/research/projects/>.

More info about city and Faculty in short videos:

[Novi Sad city](#)

[Faculty of Sciences](#)

### Congress Welcome reception – Monday, July 13, start at 5 pm

The Congress Welcome Reception will take place at the Faculty of Sciences, in the Main Hall on the ground floor. If the weather is favorable, it will extend to the area in front of the main building (known as Blue Building). The event location is Trg Dositeja Obradovića 3, 21000 Novi Sad. All registered participants are invited to attend. **Prior to the event, you will receive a sticker badge to identify you as a delegate of ICB2026.**



### Gala Dinner – Wednesday, July 15, start at 7 pm

All delegates are welcome to participate in the Congress Gala Dinner, which will be held at a cozy restaurant in the urban area of Novi Sad.

*Details about the dinner location and organized transport from the Congress venue to the restaurant (and back) will be provided in the Final Call.*

## Session and meeting locations

The working part of ICB2026 will be held in the rooms and halls of the Faculty of Sciences, which includes the main 'Blue Building' in the center and two additional buildings on the left and right. For parallel sessions, three amphitheatres and one classroom are available. If more space is needed, two additional amphitheatres with 117 seats each are reserved. Classrooms S1 and S2 will be available for meetings of the ISB EB, Editorial Board of IJB, ISB Commissions, etc. **If you plan to hold a meeting during ICB2026, it is essential to notify the Local Organizing Committee at least 10 days before the Congress and send your request via email: [nsucl@pmf.uns.ac.rs](mailto:nsucl@pmf.uns.ac.rs).**



## Parallel sessions

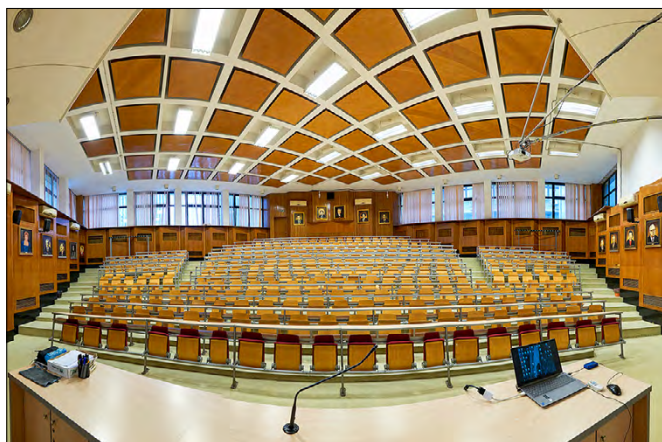

▲ Amphitheater „Mihajlo Pupin“ or A1 (370 seats) – Plenary sessions and large parallel sessions. [Learn more about Mihajlo Pupin](#), a Serbian-American scientist.



▲ Amphitheater 7 – A7 (156 seats) – Parallel sessions



▲ Amphitheater 5 – A5 (98 seats) – Parallel sessions



▲ Classroom S1 (80 seats) – Small parallel sessions and planned meetings



## Poster sessions

Poster boards (A1 size, portrait) will be placed in the hall connecting all three amphitheatres (Plenary and Parallel sessions). Each poster will be displayed at the beginning of the Poster session day (9 am) and taken down at the end of the same day (6 pm). Specific time and board numbers for each poster presenter, as well as poster technical details, **will be defined in the final Congress Program, which will be published in the Final Call.**



## Coffee breaks and lunch time

Coffee breaks (Tuesday, Wednesday, Thursday) and lunch (*Tuesday only*) between sessions be provided and take place in the main hall on the ground floor of the 'Blue Building'. If the weather is nice, coffee breaks and lunch may also be held in the open space in front of the building.

The coffee break menu will include black coffee (with sugar and milk), a variety of teas, still/sparkling water, juice, savory pastries, and sweets. The lunch menu contains regular (with meat) and vegan options. The lunch will be organized in Tuesday and is include in the Congress fee. Each participant must indicate any vegan meal preferences or allergy restrictions on the registration form.



**Note:** smoking areas – Break (gazebo) and open space in the front of the 'Blue Building' (see Congress venue plans).

## Assistance desk and badges

The registration/help desk will be open all three days of the Congress, from 8 AM to 6 PM, and will be located in the main hall on the ground floor of the 'Blue Building'. At this desk, delegates can pick up their personalized badges and Congress materials, or receive assistance. Volunteers, who are available to help, will wear visible stickers on their clothing with the announcement "Ask me for help".

Personalized name badges will be provided to all registered Congress delegates. Please wear your badge throughout the Congress to ensure access to all meeting rooms, meal services, and other Congress activities. Your name badge will also serve as your admission ticket to the Congress Gala dinner.

## Internet access in the facility

During the Congress, **WiFi will be available throughout all areas.** Information regarding the username and password will be provided in the Final Call and in the facility rooms. Additionally, **Eduroam** will be accessible for delegates if needed.

## Congress venue entrances



- ▲ Entrances 1 and 2 - Assistance desk, Welcome Reception, breaks, Congress meetings, small parallel sessions;
- Entrance 3 – Plenary sessions, Parallel sessions, Poster session

## Congress venue plans – working spaces are highlighted

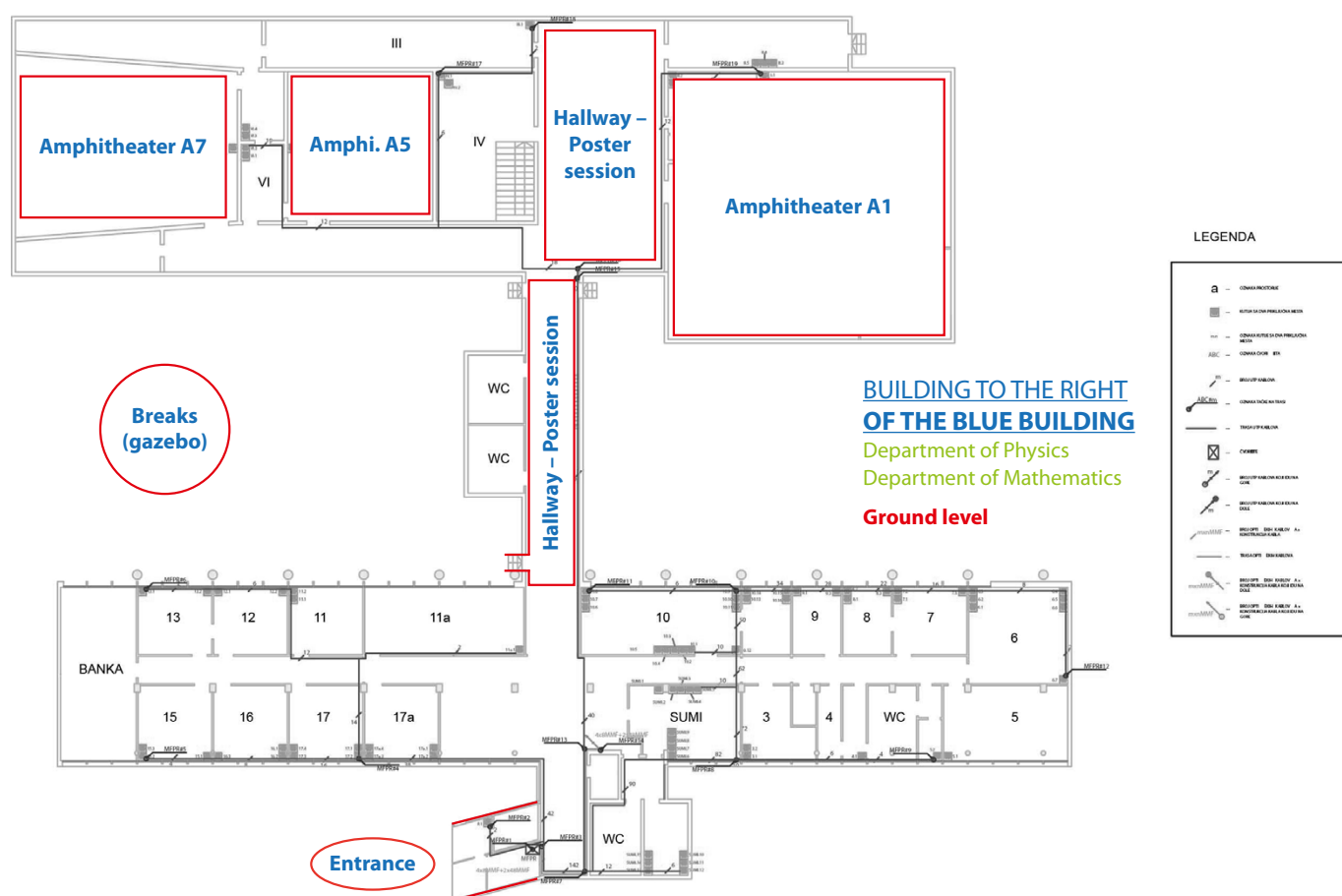

- ▲ Session rooms (Amphitheatres) and Poster area (building right from the 'Blue Building' - Entrance 3)

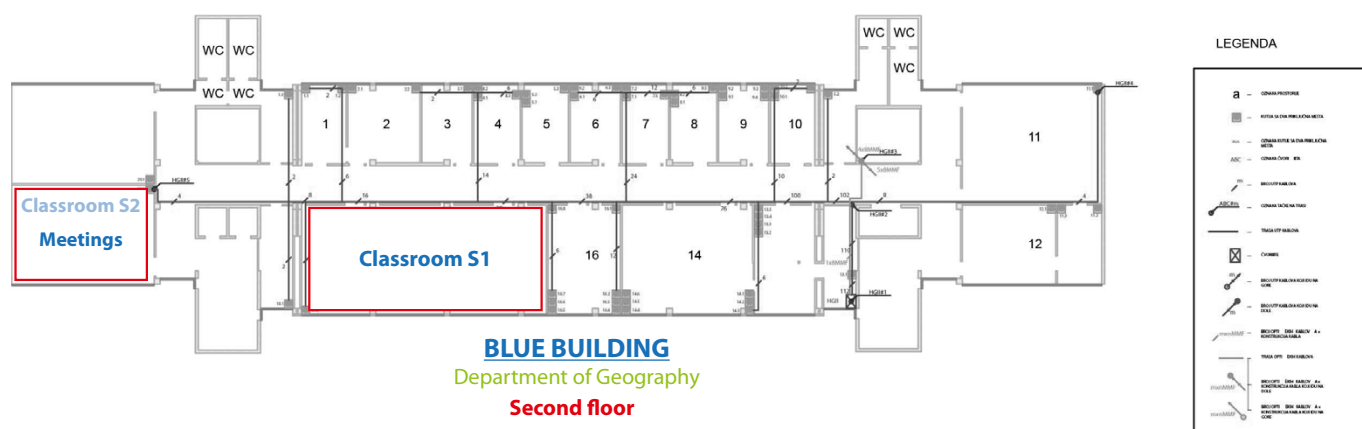

▲ Session and meeting rooms in the 'Blue Building' (second floor)

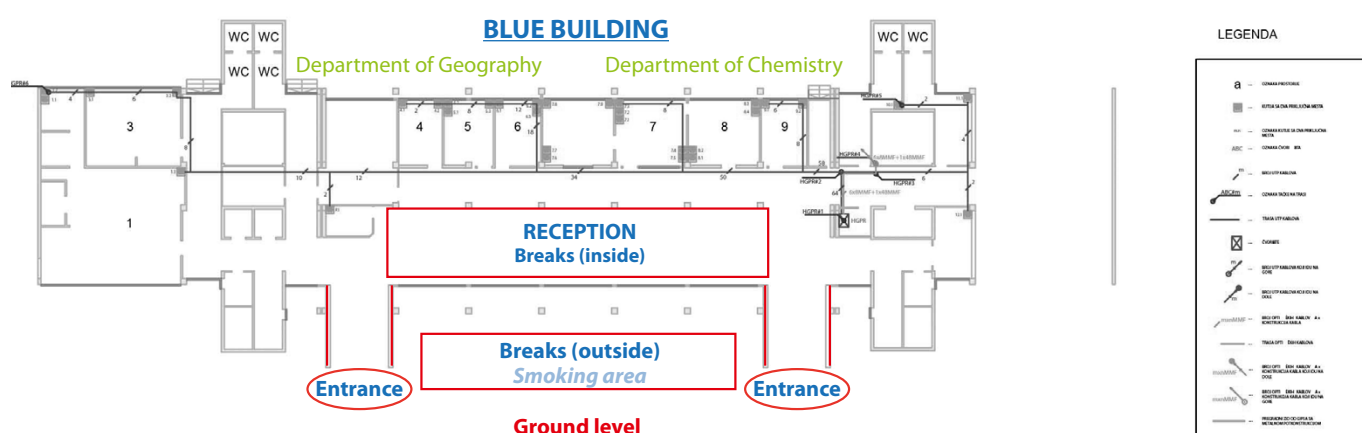

▲ Assistance desk, break/lunch area and Welcome reception location in the 'Blue Building' (ground level)

## TRANSPORT TO NOVI SAD AND CONGRESS VENUE

### Transport from Belgrade/BG Airport „Nikola Tesla“ to Novi Sad 'by train'

From the BG „Nikola Tesla“ airport to the main train station in Belgrade („Beograd centar“), the best option is to use the [bus line 600](#) (one useful [link](#) more)

Then from the **main train station „Beograd Centar“** there are about [35 departures](#) to Novi Sad between 5:30h to 23:30h. The trip lasts 36 minutes with Intercity train to 57 minutes with Regio train.

Currently, public transport in Belgrade is free, and train ticket can be bought at the main station counter, by [online](#) or on ticket machine inside the station building.

From the BG „Nikola Tesla“ airport to the main train station in Belgrade („Beograd centar“), can be used [taxi service](#). In the airport arrival zone is taxi station and the price from airport to the main train station is up to 30 €. Then the next step is to take the train to Novi Sad.

### Transport from Belgrade/BG Airport „Nikola Tesla“ to Novi Sad 'by taxi'

Here are some of the companies that you can contact for shared or individual taxi: [Autoturist](#) and [Genelex](#).

The prices and contacts are at the websites. Important thing is to book the car 2 days earlier, via e-mail or

online form, so you can get the confirmation. Naturally, it is the most expensive if you rent a car alone (up to 60€) but if you manage to share it with your colleagues it can be more affordable.

## Public transport in Novi Sad

**Bus lines** – At the following links ([timeline](#), [network](#)) you can find the timeline and map of the public transportation lines in Novi Sad. Tickets are available in the bus and the price is approximately 0.9 EUR (100 RSD).

**Taxi service** – At the following [link](#) you can find taxi companies in Novi Sad and phone numbers.

## Suggestions for accomodation

Novi Sad has about 330,000 inhabitants and plenty of hotels and apartments, but due to possible parallel events and the [EXIT festival](#) in July, booking of accommodation has to be done a few months before ICB2026.

## Accessibility of entry into Serbia

No visa requires (30-90 days of stay): EU countries (27), Albania, Andora, Antigua & Barbuda, Argentina, Armenia, Australia, Azerbaijan, Bahamas, Bahrain, Barbados, Belorussia, Bosnia and Herzegovina, Brazil, Canada, Chile, China, Columbia, Costa Rica, Dominica, Georgia, Grenada, Iceland, Indonesia, Izrael, Jamaica, Japan, Kazakhstan, Korea-Republic, Kyrgyzstan, Liechtenstein, Mexico, Moldavia, Monaco, Mongolia, Montenegro, New Zealand, North Macedonia, Norway, Palau, Paraguay, Peru, Russia, Saint Kitts and Nevis, Saint Vincent and the Grenadines, San Ma-

rino, Seychelles, Singapore, Suriname, Switzerland, Trinidad and Tobago, Turkey, Ukraine, UAE, UK, USA, Uruguay, Vatikan.

Updated information on the visa regime can be found at this [link](#). Please follow the visa information provided and also check with the Serbian embassy in your country for any additional requirements!

*After registering on the ICB2026 portal, participants will receive an email within the next 30 calendar days containing an invitation letter to use for visa applications or conference funding requests.*

## ICB2026 - GENERAL INFORMATION

The Congress will be held from July 13th to 16th in 2026 using a hybrid format, which includes both onsite presentations/posters and online presentations. All session rooms are equipped for both onsite and online presentations, allowing for questions and discussions between onsite and online participants.

## Oral presentation

Presentations are scheduled in **15-minute intervals**. Speakers should prepare for 10 minutes of remarks, followed by four minutes for questions and discussion, and one minute for transitioning to the next presentation.

Speakers are invited to send their presentations in PowerPoint or PDF format via email ([nsucl@pmf.uns.](mailto:nsucl@pmf.uns.ac.rs)

[ac.rs](#)) two days before the Congress begins, or to bring a USB flash drive to upload their presentation onsite to a laptop in each meeting room before the session starts. Volunteers will be available during each session to assist you in uploading your presentation to the laptop.



## Poster presentation

---

Poster session will be displayed in **Wednesday, July 15, 2026** in the hall connecting the session rooms. The time for poster session will be 1-2 hours before or after the lunch break, with the final decision depending on the overall session schedule. Presenters should set up their posters in the morning (by 9 AM) on the day of the session, remain near their posters during the official poster session time, and remove their posters by the end of the day (no later than 6 PM). **In the Final Call, poster presenters will find**

**the time and board number for their poster session.** Additional technical details regarding poster size and visibility will also be included in the Final Call.

Online poster presentations will not be possible at the Congress. Additionally, assistance with printing posters at the Congress venue will not be available. However, volunteers can help by directing you to local printing services that can accommodate your needs (there are a few options in and around the UNI campus).

## Online presentation and joining virtually

---

Registered delegates are invited to view a live stream of all plenary and oral sessions if they are unable to attend in person. Online speakers will have the same time guidelines for their presentations as onsite oral speakers (see Oral Presentation). The University of Novi Sad holds an official license for **Webex by Cisco**

and Faculty of Sciences holds an official license for **Zoom Meetings**, which allows us to create separate links for each session room during the Congress. By logging into the specific link, online participants can present their own presentations or follow those of others in the session.

## Awards

---

More info in the Second call and Final call.

## Registration and abstract submission

---

Your registration and abstract submission can be done only by using the online platform. Link to platform: **will be available from October 2025.**

Instruction of registration and abstract submission – **will be part of the ICB2026 Second call (October 2025).**

## Congress fee payment

---

1. The **Faculty of Sciences** does not have the possibility of an online system through which registration fees would be paid (like PayPal, Copernicus Meetings, or similar).
2. Fee payments can be made from account to account, that is, from the participant's institution to the **Faculty of Sciences** sub-account (located in National Bank of Serbia), or from the participant's bank to the **Faculty of Sciences** sub-account (located in National Bank of Serbia).
3. The **Faculty of Sciences** will create a detailed and clear specification for payment, so that all officers making payments within the institution or bank will be able to complete the transaction without any problems.
4. The payment will be realized through the Proforma invoice and Fee payment instruction.
5. Registration fee amounts will be available in the ICB2026 Second call (October 2025).

## Be volunteer on the ICB2026!

---

If you are a student or new professional from lower-middle and low-income countries according to [World Bank](#) and are interested in participating in the Congress through work at assistance desks or providing technical support during sessions, we welcome you to apply as a volunteer. Anyone interested should send their CV to the Congress' official email ([nsucl@pmf.](mailto:nsucl@pmf.)

[uns.ac.rs](mailto:nsucl@pmf.)) along with a one-page motivation letter. The application period will begin with the registration period (October 2025) and continue until the end of January 2026. During this time, interested students and new professionals may submit their applications. Selected students and new professionals will have their Congress fees waived.

## General session program

---

Will be announced in the ICB2026 Second call (October 2025).

## Plenary Session Speakers

---

Final list of Plenary speakers will be announced in the ICB2026 Final call.

## ICB2026 Scientific Board

---

- **Scott C. Sheridan**, Department of Geography, Kent State University, Kent, OH, USA (President of the International Society of Biometeorology)
- **Daniel Vecellio**, University of Nebraska Omaha, College of Arts and Sciences, USA
- **Angela Lees**, School of Agriculture and Food Sciences, Animal Science Group, The University of Queensland, Gatton, QLD, Australia
- **Fabio Luix Teixeira Goncalves**, University of Sao Paulo, Institute of Astronomy, Geophysics and Atmospheric Sciences, Brazil
- **Jennifer Fitchett**, University of the Witwatersrand, School of Geography, Archaeology and Environmental Studies, South Africa
- **Shreya Banerjee**, Indian Institute of Technology, Kharagpur, India
- **Athanasios Damialis**, Aristotle University, Greece
- **Ivana Bajšanski**, University of Novi Sad, Faculty of Technical Sciences, Serbia
- **Alison Donnelly**, Department of Geography, University of Wisconsin-Milwaukee, Milwaukee, WI, USA
- **Pablo Fernández de Arróyabe Hernáez**, University of Cantabria, Department of Geography, Urban Planning and Territorial Planning, Santander, Spain
- **Peter Crank**, University of Waterloo, Geography and Environmental Management, Canada
- **Sheila Nascimento**, State University of Maringá, Brazil
- **Adam Kalkstein**, United States Military Academy West Point, Chair of Regional Dynamics, Center for Languages, Cultures and Regional Studies, USA
- **Krzysztof Błażejczyk**, Polish Academy of Sciences, Institute of Geography and Spatial Organization, Warsaw, Poland
- **Marie Keatley**, RMIT University, School of Science, Australia
- **Robert Steiger**, University of Innsbruck, Department of Public Finance, Austria
- **Elena A. Grigorieva**, Geography Department, Humboldt-Universität zu Berlin, Berlin, Germany
- **Zorana Jovanović Andersen**, University of Copenhagen, Department of Public Health, Denmark
- **Sandra Słowińska**, Institute of Geography and Spatial Organization, Polish Academy of Sciences, Warsaw, Poland
- **Matej Ogrin**, University of Ljubljana, Faculty of Arts, Slovenia
- **Matt Smith**, School of Science and the Environment, University of Worcester, Worcester, UK
- **Pavel Konstantinov**, Lomonosov Moscow State University, Department of Meteorology and Climatology, Russia
- **Andrea Vitali**, Tuscia University, Viterbo, Italy



- **Louis Kouadio**, Centre for Applied Climate Sciences, University of Southern Queensland, Toowoomba, QLD, Australia
- **Ljiljana Tubić**, Institute for Biology Research „Sinisa Stankovic“, Department of Plant Physiology, Serbia
- **Tzu-Ping Lin**, Department of Architecture, National Chen Kung University, Tainan, Taiwan
- **Rebecca Darbyshire**, CSIRO – Agriculture and Food, Canberra, ACT, Australia
- **Dragan Milošević**, Wageningen University and Research, Environmental Sciences Group, The Netherlands
- **Magdalena Kuchcik**, Polish Academy of Sciences, Institute of Geography and Spatial Organization, Poland
- **Rong Yu**, State Key Laboratory of Subtropical Silviculture, Zhejiang A&F University, Hangzhou, China
- **Michal Lehnert**, Palacky University Olomouc, Faculty of Sciences, Czech Republic
- **Tania Sharmin**, Cardiff University, Welsh School of Architecture, UK
- **Antonella Fioravanti**, Azienda Ospedaliera Universitaria Senese, Siena, Italy
- **Dubravka Milić**, University of Novi Sad, Faculty of Sciences, Serbia
- **Steven Caluwaerts**, Ghent University, Faculty of Sciences, Belgium
- **Aleš Urban**, Institute of Atmospheric Physics, Czech Academy of Sciences, Prague, Czech Republic
- **Simone Orlandini**, Department of Agriculture, Food, Environment and Forestry (DAGRI), University of Florence, Florence, Italy
- **Rodrigo Arias**, Instituto de Producción Animal, Universidad Austral de Chile, Valdivia, Chile
- **Lea Labeur**, Murdoch University, Perth, WA, Australia
- **Ulises Macías-Cruz**, Institute of Agricultural Sciences, Autonomous University of Baja California, Mexicali, Mexico
- **Ana Santurtún**, Department of Physiology and Pharmacology, University of Cantabria, Santander, Spain
- **David Hondula**, Arizona State University, Tempe, AZ, USA
- **Kathryn Conlon**, M.P.H., Department of Public Health Sciences, School of Medicine, Department of Medicine & Epidemiology, School of Veterinary Medicine, University of California Davis, Davis, CA, USA
- **Chung-Te Chang**, Department of Life Science, Tung-hai University, Taichung City, Taiwan
- **Teng-Chiu Lin**, Department of Life Science, National Taiwan Normal University, Taipei, Taiwan
- **Pavlos Kassomenos**, University of Ioannina, Ioannina, Greece
- **Mark D. Schwartz**, Department of Geography, University of Wisconsin-Milwaukee, Milwaukee, WI, USA
- **Gijsbert Hoogendoorn**, Department of Geography, University of Johannesburg, Johannesburg, South Africa
- **Bo Hong**, College of Landscape Architecture and Arts, Northwest A&F University, Yangling, China

## ICB2026 Local Organizing Committee

- **Dušan Mrđa**, vice-dean for science, University of Novi Sad, Faculty of Sciences
- **Danijela Rajter Ćirić**, vice-dean for finance, University of Novi Sad, Faculty of Sciences
- **Lazar Lazić**, director of the Department of Geography, Tourism and Hotel Management
- **Danka Popov**, manager of accounting office (work on congress fee issues)
- **Kristina Radanović**, technical associate (work on congress fee issues)
- **Ivan Gačević**, technical associate (work on IT issues)
- **Stevan Savić**, University of Novi Sad, Faculty of Sciences
- **Ivan Šećerov**, University of Novi Sad, Faculty of Sciences
- **Jelena Dunjić**, University of Novi Sad, Faculty of Sciences
- **Daniela Arsenović**, University of Novi Sad, Faculty of Sciences
- **Michael Allen**, Towson University, USA
- **Milica Vasić**, University of Novi Sad, Faculty of Sciences
- + Volunteers

## Timeline

DATE	ACTION
30 June 2025	First call with ICB2026 general information
15 October 2025	Call for registration and abstract submission opens
15 October 2025	Call for volunteers application (details in First/Second calls)
15 January 2026	Deadline for registration and abstract submissions
31 January 2026	Deadline for volunteer application (details in First/Second calls)
15 February 2026 at latest	Letter of acceptance to authors
15 February 2026	Decision letter to selected volunteers
16 February - 15 May 2026	Early-bird fee payments period
15 May 2026	Preliminary Congress program (available on the webpage)
16 May - 1 July 2026	Standard fee payments period
3 July 2026	Deadline for notifying the interest to organize meeting within the ICB2026
10 July 2026	Final Congress program (available on the webpage)
13-16 July 2026	24th International Congress of Biometeorology